

**Universal Tool**

**AIRCRAFT TOOLS**



## UT8662-TC Aero Riveting Hammer (2X)

- Tungsten carbide piston provides more powerful blows... smaller tool for the same application
- Contoured ergonomic handle design
- Precision engineered spool valve for precision control on the job
- Triple heat treated alloy steel cylinder
- All metal trigger and throttle valve for durability

**Best for: MRO and general Repair**



## UT8663-TC Aero Riveting Hammer (3X)

- Tungsten carbide piston provides more powerful blows... smaller tool for the same application
- Contoured ergonomic handle design
- Precision engineered spool valve for precision control on the job
- Triple heat treated alloy steel cylinder
- All metal trigger and throttle valve for durability

**Best for: MRO and general Repair**



## UT8665-TC Aero Riveting Hammer (5X)

- Tungsten carbide piston provides more powerful blows... smaller tool for the same application
- Contoured ergonomic handle design
- Precision engineered spool valve for precision control on the job
- Triple heat treated alloy steel cylinder
- All metal trigger and throttle valve for durability

**Best for: MRO and general Repair**

Model #	Retainer	Housing Material	Bushing (in)	Blows Per Minute	Bore (in)	Stroke (in)	Capacity Aluminum (in)	Capacity Steel (in)	Weight (lb)	Weight (kg)	Length (in)	Length (mm)	Air Inlet (npt)	Rec. Hose (id. in)	Air Cons. (cfm)	Avg. Air Cons. (cfm)
UT8662-TC	Spring	Aluminum	0.401	2,600	1/2	2-1/4	3/16	1/8	2.7	1.2	5.5	140	1/4"	3/8"	28.0	7.0
UT8663-TC	Spring	Aluminum	0.401	2,160	1/2	2-7/8	1/4	3/16	2.9	1.3	7.0	177	1/4"	3/8"	28.0	7.0
UT8665-TC	Spring	Aluminum	0.401	2,000	1/2	3-7/8	5/16	1/4	3.5	1.6	9.4	240	1/4"	3/8"	28.0	7.0

Recommended Air Pressure of 90 psi - 6.2 bar

# TUNGSTEN CARBIDE AERO RIVETING HAMMERS & PRECISION AIRCRAFT DRILLS & INTERNAL SPLINE DRIVE TOOLS



## UT8892 Precision Pistol Drill Series

- Machined carbon fiber blades for lubrication free operation
- Highest precision engineering ensures 600,000 cycles of use
- Internal silencer baffle reduces noise pressure level to 82 dBA
- Precision needle bearings and gears and gear case interchangeable with leading brand
- Advanced ergonomic handle design with insulated coating for maximum operator comfort
- Ported throttle valve for precise variable speed control

**Best for: Continuous precision air frame work**



## UT8892SP Internal Spline Drive Tool Series

- Machined carbon fiber blades for lubrication free operation
- Highest precision engineering ensures 600,000 cycles of use
- Internal silencer baffle reduces noise pressure level to 82 dBA
- Precision needle bearings and gears and gear case interchangeable with leading brand
- Advanced ergonomic handle design with insulated coating for maximum operator comfort
- Ported throttle valve for precise variable speed control
- Internal spline drive for use with Universal Tool or Jiffy® "L"- Foot and Pancake Drilling Attachments

**Best for: Continuous precision air frame work**

Model #	Motor (hp)	Motor (Kw)	Gear Ratio	Throttle Style	Speed (rpm)	Exhaust	Chuck	Weight (lb)	Weight (kg)	Length (in)	Length (mm)	Air Inlet (npt)	Rec. Hose (id. in)	Air Cons. (cfm)	Avg. Air Cons. (cfm)
UT8892-5	0.45	0.33	40:1	Ported	500	Rear	1/4"	1.30	0.60	7.50	191	1/4"	3/8"	16.0	4.0
UT8892-10	0.45	0.33	20:1	Ported	1,000	Rear	1/4"	1.30	0.60	7.50	191	1/4"	3/8"	16.0	4.0
UT8892-24	0.45	0.33	9:1	Ported	2,400	Rear	1/4"	1.20	0.54	7.40	188	1/4"	3/8"	16.0	4.0
UT8892-33	0.45	0.33	6:1	Ported	3,300	Rear	1/4"	1.20	0.54	7.40	188	1/4"	3/8"	16.0	4.0
UT8892-45	0.45	0.33	5:1	Ported	4,500	Rear	1/4"	1.20	0.54	7.40	188	1/4"	3/8"	16.0	4.0
UT8892-60	0.45	0.33	3.3:1	Ported	6,000	Rear	1/4"	1.20	0.54	7.40	188	1/4"	3/8"	16.0	4.0
UT8892-200	0.45	0.33	1:1	Ported	20,000	Rear	1/4"	1.20	0.54	7.40	188	1/4"	3/8"	16.0	4.0
UT8892SP-5	0.45	0.33	40:1	Ported	500	Rear	Internal Spline	1.10	0.50	6.25	159	1/4"	3/8"	16.0	4.0
UT8892SP-10	0.45	0.33	20:1	Ported	1,000	Rear	Internal Spline	1.10	0.50	6.25	159	1/4"	3/8"	16.0	4.0
UT8892SP-24	0.45	0.33	9:1	Ported	2,400	Rear	Internal Spline	1.05	0.48	6.25	159	1/4"	3/8"	16.0	4.0
UT8892SP-33	0.45	0.33	6:1	Ported	3,300	Rear	Internal Spline	1.05	0.48	6.25	159	1/4"	3/8"	16.0	4.0

Recommended Air Pressure of 90 psi - 6.2 bar



## UT8898

### Aircraft Drill Series

- 0.7 HP Motor for ultimate stall resistance
- Machined carbon fiber blades for lubrication free operation
- Highest precision engineering ensures 600,000 cycles of use
- Advanced ergonomically designed handle with "Softouch" coating offers ultimate comfort and reduced vibration
- Ported throttle valve for ultimate control and reliability
- Through handle exhaust with built-in silencing baffle reduces noise level to 83dBa
- Precision engineered to guarantee runout of less than .0015"

**Best for: Continuous precision air frame work**

Model #	Motor (hp)	Motor (kw)	Throttle Style	Speed (rpm)	Exhaust	Chuck (in)	Weight (lb)	Weight (kg)	Length (in)	Length (mm)	Air Inlet (npt)	Rec. Hose (id. in)	Air Cons. (cfm)	Avg. Air Cons. (cfm)
UT8898-3	0.70	0.66	Ported	300	Handle	3/8"	2.1	0.90	7.90	201	1/4"	3/8"	22.0	5.5
UT8898-5	0.70	0.66	Ported	500	Handle	3/8"	2.1	0.90	7.90	201	1/4"	3/8"	22.0	5.5
UT8898-13	0.70	0.66	Ported	1,300	Handle	3/8"	2.1	0.90	7.90	201	1/4"	3/8"	22.0	5.5
UT8898-26	0.70	0.66	Ported	2,600	Handle	3/8"	2.0	0.85	7.20	183	1/4"	3/8"	22.0	5.5
UT8898-33	0.70	0.66	Ported	3,300	Handle	3/8"	2.0	0.85	7.20	183	1/4"	3/8"	22.0	5.5
UT8898-60	0.70	0.66	Ported	6,000	Handle	1/4"	2.0	0.75	7.20	183	1/4"	3/8"	22.0	5.5

Recommended Air Pressure of 90 psi - 6.2 bar



UT8891 Low Profile Drill Attachment

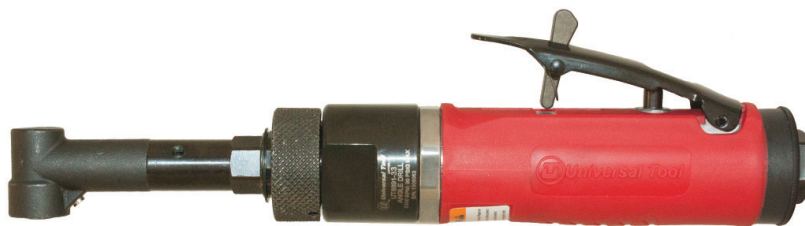

UT8891HD Heavy Duty Drill Attachment

## UT8891

### Aircraft Angle Drill Series

- 0.45 HP motor ensures no slow down & clean break through
- Machined carbon fiber blades for lubrication free operation
- Highest precision engineering ensures 600,000 cycles of use
- Internal silencer baffle reduces noise pressure to 81 dBA
- Precision engineered angle head and gears supported by ball bearings; and 1/4" x 28 TPI internal thread
- Motor parts 100% interchangeable with UT8892 pistol drills and UT8724 die grinder series
- Angle head interchangeable with UT8893 series

**Best for: Continuous precision air frame work**

Model #	Motor (hp)	Motor (Kw)	Gear Ratio	Speed (rpm)	Exhaust	Chuck	Weight (lb)	Weight (kg)	Length (in)	Length (mm)	Air Inlet (npt)	Rec. Hose (id. in)	Air Cons. (cfm)	Avg. Air Cons. (cfm)
UT8891-5	0.45	0.33	40:1	500	Rear	1/4" x 28 TPI	1.87	0.85	10.25	260	1/4"	3/8"	16	4.0
UT8891-10	0.45	0.33	20:1	1,000	Rear	1/4" x 28 TPI	1.87	0.85	10.25	260	1/4"	3/8"	16	4.0
UT8891-24	0.45	0.33	9:1	2,400	Rear	1/4" x 28 TPI	1.66	0.75	9.75	248	1/4"	3/8"	16	4.0
UT8891-33	0.45	0.33	6:1	3,300	Rear	1/4" x 28 TPI	1.66	0.75	9.75	248	1/4"	3/8"	16	4.0
UT8891-45	0.45	0.33	5:1	4,500	Rear	1/4" x 28 TPI	1.66	0.75	9.75	248	1/4"	3/8"	16	4.0
UT8891-60	0.45	0.33	3.3:1	6,000	Rear	1/4" x 28 TPI	1.66	0.75	9.75	248	1/4"	3/8"	16	4.0
UT8891HD-5	0.45	0.33	40:1	500	Rear	1/4" x 28 TPI	1.87	0.85	10.25	260	1/4"	3/8"	16	4.0
UT8891HD-10	0.45	0.33	20:1	1,000	Rear	1/4" x 28 TPI	1.87	0.85	10.25	260	1/4"	3/8"	16	4.0
UT8891HD-24	0.45	0.33	9:1	2,400	Rear	1/4" x 28 TPI	1.66	0.75	9.75	248	1/4"	3/8"	16	4.0
UT8891HD-33	0.45	0.33	6:1	3,300	Rear	1/4" x 28 TPI	1.66	0.75	9.75	248	1/4"	3/8"	16	4.0
UT8891HD-45	0.45	0.33	5:1	4,500	Rear	1/4" x 28 TPI	1.66	0.75	9.75	248	1/4"	3/8"	16	4.0
UT8891HD-60	0.45	0.33	3.3:1	6,000	Rear	1/4" x 28 TPI	1.66	0.75	9.75	248	1/4"	3/8"	16	4.0

Recommended Air Pressure of 90 psi - 6.2 bar



## UT8895RSP / UT8896RSP Reversible Internal Spline Drive Tool

- 0.8 HP Motor for ultimate stall resistance
- Fully caged gears with needle bearings for ultimate reliability
- Ported throttle valve for ultimate control and reliability
- Through handle exhaust with built-in silencing system
- Advanced ergonomically designed handle with "Softouch" coating offers ultimate comfort and reduced vibration
- Internal spline drive for use with Universal Tool or Jiffy® "L"- foot and pancake drilling attachments
- Reversible for back drilling requirements

**Best for: Continuous precision air frame work**



UT8893 Series



UT8893S Series

## UT8893 Aircraft Angle Drill Series

- 0.9 HP motor ensures no slow down & clean break through even for larger diameter holes in high grade special alloy materials
- Highest precision engineering ensures 600,000 cycles of use
- Internal silencer baffle reduces noise pressure to 78 dBA
- Advanced ergonomic handle design with insulated coating for maximum operator comfort

• Ported throttle valve for precise variable speed control  
**Best for: Continuous precision air frame work and general industrial applications**

## UT8893M-Motor Only

Model #	Motor (hp)	Motor (Kw)	Gear Ratio	Speed (rpm)	Exhaust	Chuck	Weight (lb)	Weight (kg)	Length (in)	Length (mm)	Air Inlet (npt)	Rec. Hose (id. in)	Air Cons. (cfm)	Avg. Air Cons. (cfm)
UT8895RSP	0.80	0.59	8:01	1,800	Rear	Internal Spline	2.1	1.00	7.00	178	1/4"	3/8"	18	4.5
UT8895RSP-30	0.80	0.59	6.6:1	3,000	Handle	Internal Spline	2.1	1.00	7.00	178	1/4"	3/8"	18	4.5
UT8896RSP	0.80	0.59	N/A	400	Handle	Internal Spline	2.8	1.10	7.50	197	1/4"	3/8"	18	4.5
UT8893-5	0.90	0.66	40:1	500	Rear	1/4" x 28 TPI	2.5	1.13	10.90	278	1/4"	3/8"	18	4.5
UT8893-26	0.90	0.66	8:1	2,600	Rear	1/4" x 28 TPI	2.4	1.08	10.90	278	1/4"	3/8"	18	4.5
UT8893-60	0.90	0.66	3.3:1	6,000	Rear	1/4" x 28 TPI	2.4	1.08	10.90	278	1/4"	3/8"	18	4.5
UT8893-26S	0.90	0.66	8:1	2,600	Rear	3/8"	2.4	1.08	10.25	260	1/4"	3/8"	18	4.5
UT8893-60S	0.90	0.66	3.3:1	6,000	Rear	3/8"	2.4	1.08	10.25	260	1/4"	3/8"	18	4.5
UT8893M-5	0.90	0.66	40:1	500	Rear	N/A	2.3	1.04	8.80	224	1/4"	3/8"	18	4.5
UT8893M-26	0.90	0.66	8:1	2,600	Rear	N/A	1.8	0.82	7.60	193	1/4"	3/8"	18	4.5
UT8893M-60	0.90	0.66	3.3:1	6,000	Rear	N/A	1.8	0.82	7.60	193	1/4"	3/8"	18	4.5

Recommended Air Pressure of 90 psi - 6.2 bar

# REVERSIBLE INTERNAL SPLINE DRIVE TOOLS, AIRCRAFT TOOL MOTORS & RIVET SHAVERS



## UT8891M

### Aircraft Motor Series

- 0.45 HP motor ensures no slow down & clean break through
- Machined carbon fiber blades & carbon steel motor parts allow "Oil Free" Use
- Highest precision engineering ensures 600,000 cycles of use
- Internal silencer baffle reduces noise pressure to 81 dBA
- Precision engineered angle head and gears supported by ball bearings; and 1/4" x 28 TPI internal thread
- Motor parts 100% interchangeable with UT8892 pistol drills and UT8724 die grinder series

**Best for: Continuous precision air frame work**



Model #	Motor (hp)	Motor (Kw)	Gear Ratio	Speed (rpm)	Exhaust	Weight (lb)	Weight (kg)	Length (in)	Length (mm)	Air Inlet (npt)	Rec. Hose (id. in)	Air Cons. (cfm)	Avg. Air Cons. (cfm)
UT8891M-5	0.45	0.33	40:1	500	Rear	1.4	0.64	7.00	178	1/4"	3/8"	16	4.0
UT8891M-10	0.45	0.33	20:1	1,000	Rear	1.4	0.64	7.00	178	1/4"	3/8"	16	4.0
UT8891M-24	0.45	0.33	9:1	2,400	Rear	1.2	0.54	6.25	159	1/4"	3/8"	16	4.0
UT8891M-33	0.45	0.33	6:1	3,300	Rear	1.2	0.54	6.25	159	1/4"	3/8"	16	4.0
UT8891M-45	0.45	0.33	5:1	4,500	Rear	1.2	0.54	6.25	159	1/4"	3/8"	16	4.0
UT8891M-60	0.45	0.33	3.3:1	6,000	Rear	1.2	0.54	6.25	159	1/4"	3/8"	16	4.0

Recommended Air Pressure of 90 psi - 6.2 bar

## UT8897RS

### Aircraft Rivet Shaver Series

- Precision cutter adjustment of .0005"
- Ported valve for variable speed control
- Softtouch coating for operator comfort
- Muffled through handle exhaust
- Reverse threaded skirt to keep vibration from affecting the shaving depth repeatability

**Best for: Aircraft rivets**



Model #	Motor (hp)	Motor (Kw)	Gear Ratio	Throttle Style	Speed (rpm)	Exhaust	Skirt (in)	Weight (lb)	Weight (kg)	Length (in)	Length (mm)	Air Inlet (npt)	Rec. Hose (id. in)	Air Cons. (cfm)	Avg. Air Cons. (cfm)
UT8897RS-1/4	0.9	0.66	1:1	Ported	20,000	Handle	1/4	2.6	1.10	7.75	197	1/4"	3/8"	22	4.6
UT8897RS-5/16	0.9	0.66	1:1	Ported	20,000	Handle	5/16	2.6	1.10	7.75	197	1/4"	3/8"	22	4.6
UT8897RS-3/8	0.9	0.66	1:1	Ported	20,000	Handle	3/8	2.6	1.10	7.75	197	1/4"	3/8"	22	4.6
UT8897RS-7/16	0.9	0.66	1:1	Ported	20,000	Handle	7/16	2.6	1.10	7.75	197	1/4"	3/8"	22	4.6
UT8897RS-1/2	0.9	0.66	1:1	Ported	20,000	Handle	1/2	2.6	1.10	7.75	197	1/4"	3/8"	22	4.6
UT8897RS-9/16	0.9	0.66	1:1	Ported	20,000	Handle	9/16	2.6	1.10	7.75	197	1/4"	3/8"	22	4.6
UT8897RS-5/8	0.9	0.66	1:1	Ported	20,000	Handle	5/8	2.6	1.10	7.75	197	1/4"	3/8"	22	4.6

Recommended Air Pressure of 90 psi - 6.2 bar

**Precision aircraft attachments for use with  
UT8891 / UT8893 Angle Drills and SP Series Internal Spline Tools**

**"L" Type Off-Set**

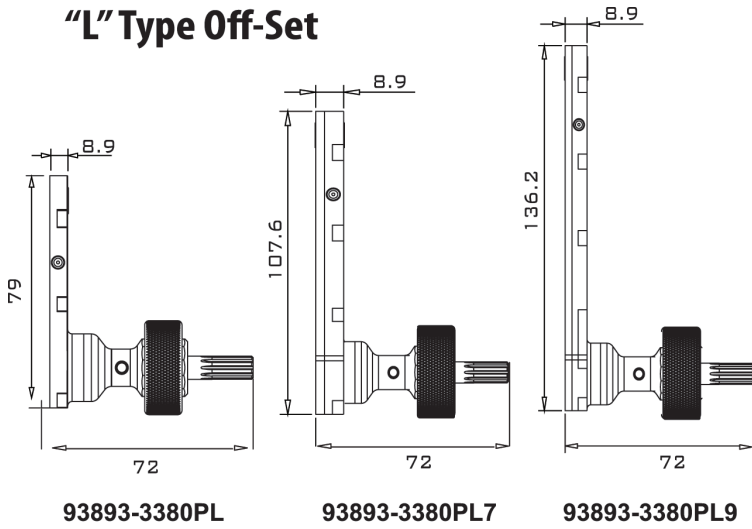

- 93893-3380PL
- 93893-3380PL7
- 93893-3380PL9
- 93893-3380PLE
- 93893-3380PLE7
- 93893-3380PLE9

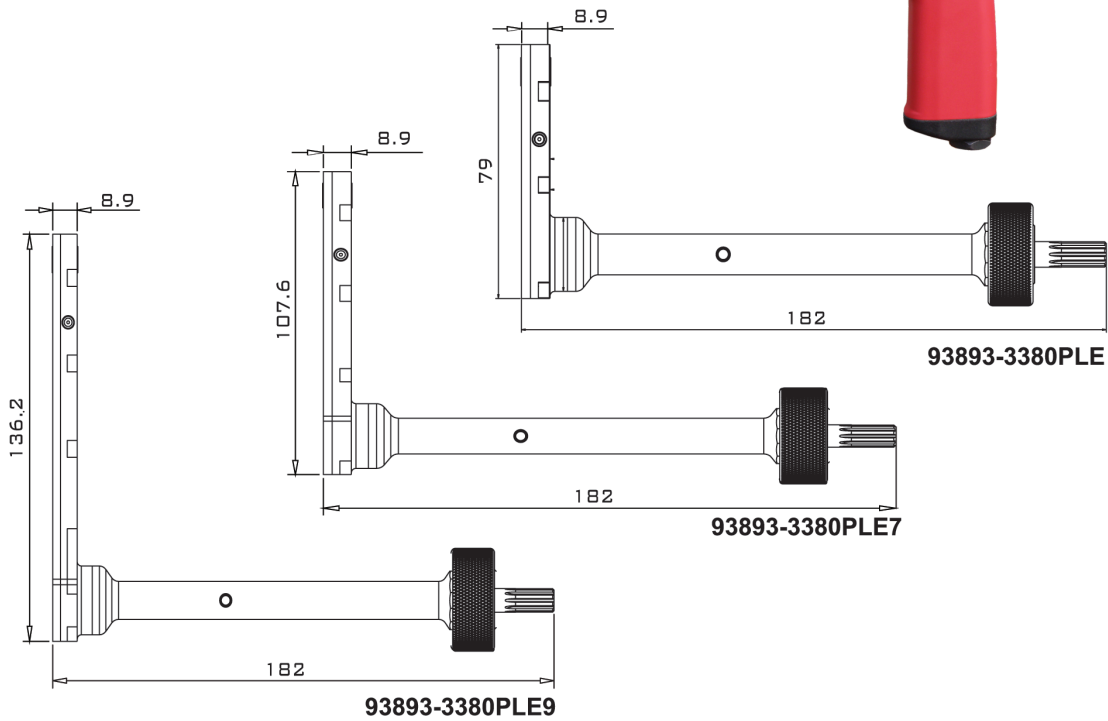



# PRECISION AIRCRAFT DRILLING ATTACHMENTS

Precision aircraft attachments for use with  
UT8891 / UT8893 Angle Drills and SP Series Internal Spline Tools

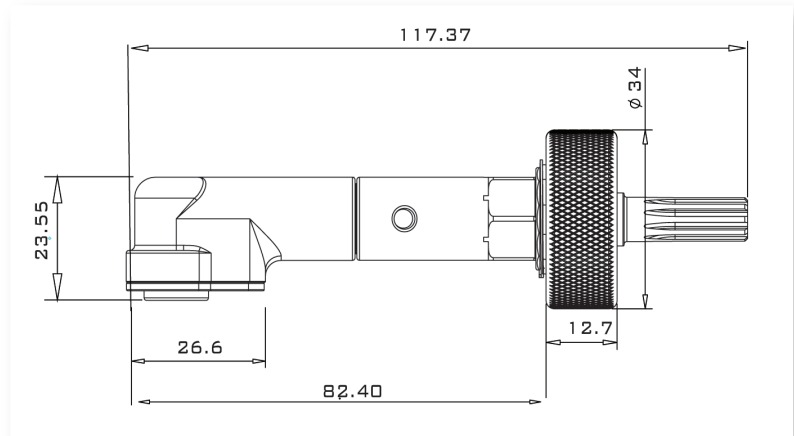

**93893-3348A**  
**90° Angle Drill Attachment**

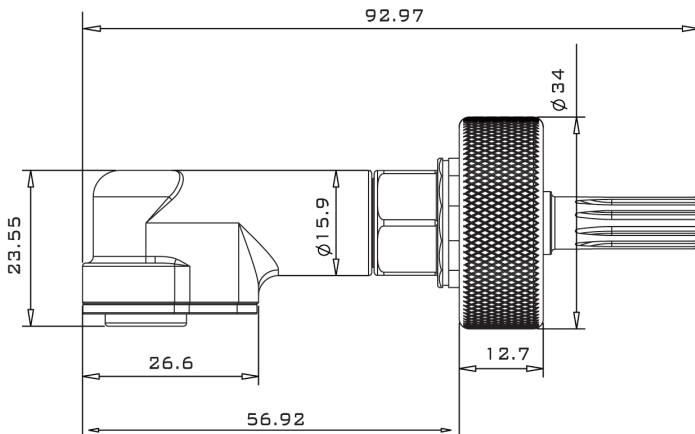

**93893-3348AS**  
**90° Short Angle Drill Attachment**

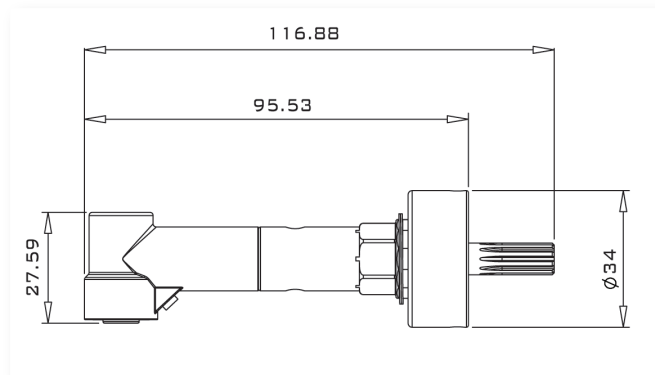

**93893-3349**  
**90° Heavy Duty Drill Attachment**

**Precision aircraft attachments for use with  
UT8891 / UT8893 Angle Drills and SP Series Internal Spline Tools**

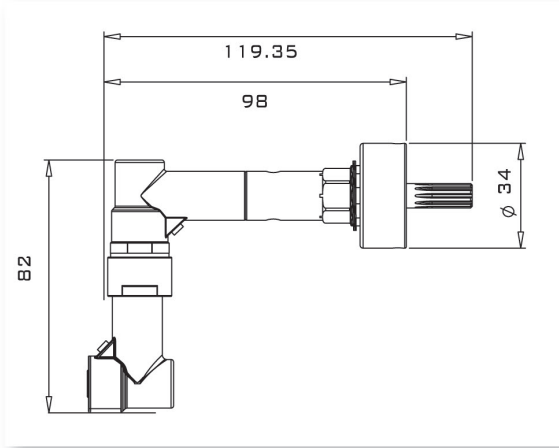

**93893-3360  
360° Drill Attachment**

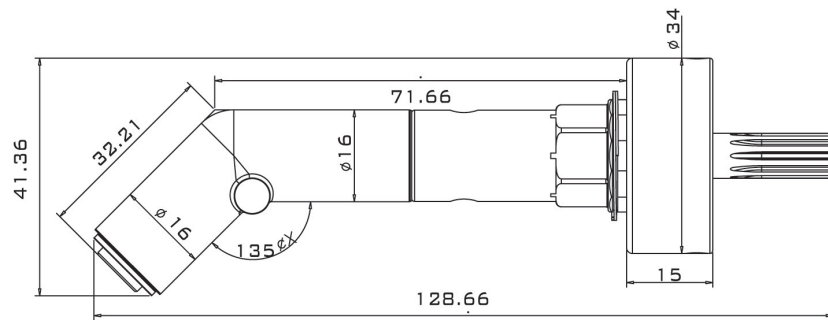

**93893-4580  
45° Angle Drill Attachment**

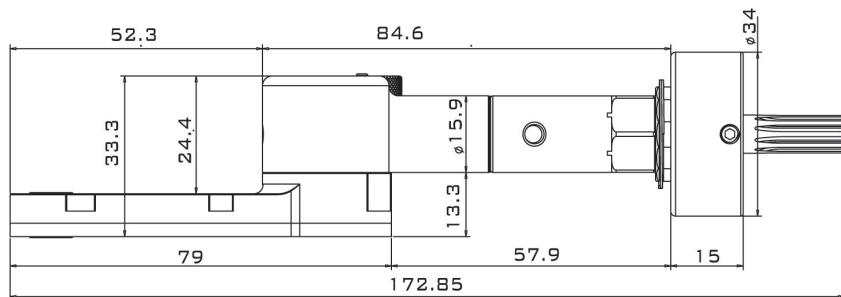

**93893-3380PS  
Indexable Drill Attachment**

# PRECISION AIRCRAFT DRILLING ATTACHMENTS

## FD Series "L" Type Off-set Attachments For Use With Standard 3 Jaw Drill Chucks (1/4-in.-1/2-in.)

93893-3380FD5

93893-3380FD7

93893-3380FD9



Can be used with reversible drills  
for back drilling applications.

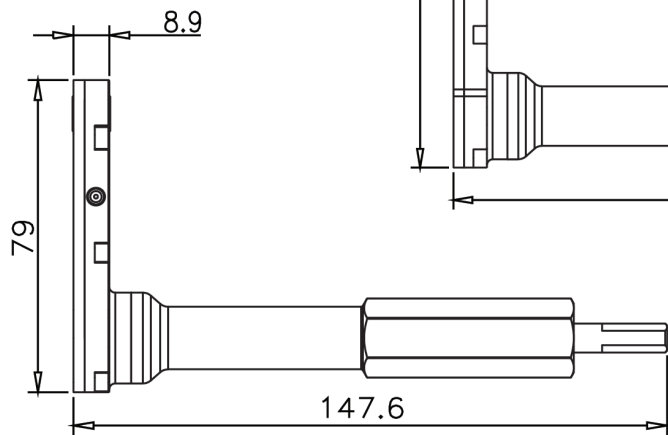
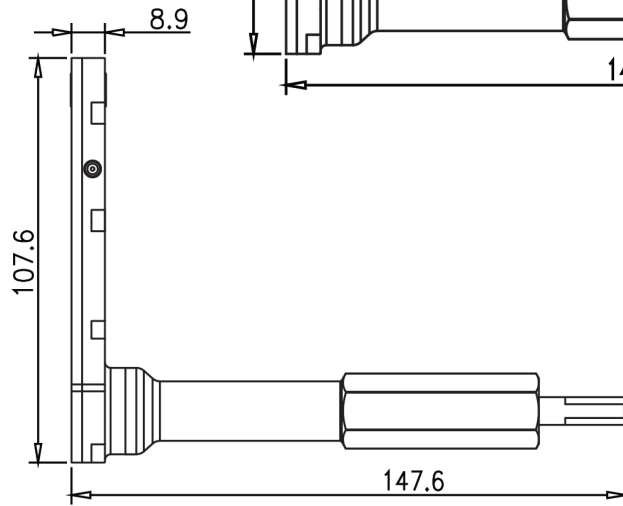
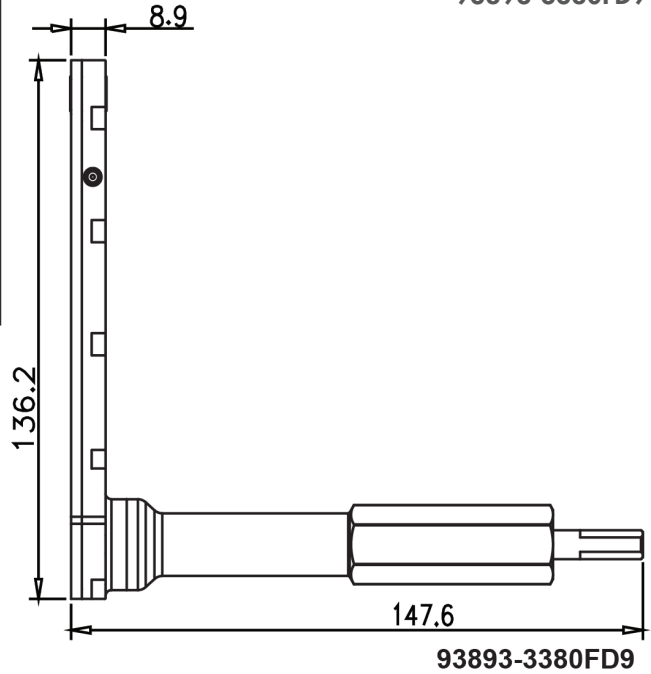

## 9300 Series Hi-Lok® Modular Installation Tools

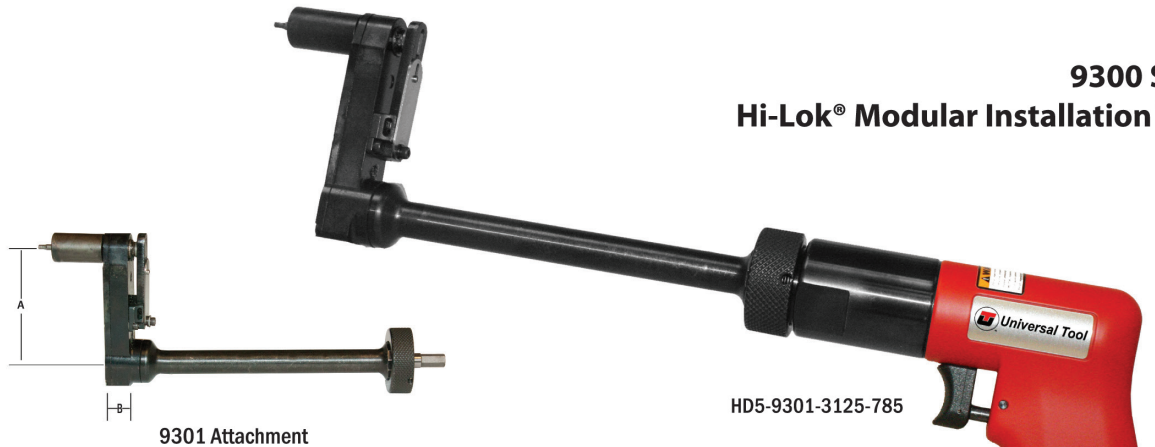

### Features

- New modular and indexable installation tool for -5 thru -8 diameter Hi-Lok/Hi-Lite® pin and collar combinations.
- Modular attachment design lends itself to point-of-use kits and travel repair kits for airframe maintenance.
- Offset attachment indexes and locks at 30° increments—allows operator maximum comfort for handle position.
- A = 2.375" B = .500"
- Available socket lengths of 1/2" and 1". Soon to have 1/4" lengths available.
- Attachment and socket assemblies interchange with other major manufacturers.
- Also available in 9301 extended version.
- **HD2.5-9300 250 rpm version also available!**



- .45 HP Motor Only for Modular & Indexable Hi-Lok® Installation Attachments
- Lubrication free
- Ported throttle for precise control
- 75 dBa

Model Number	RPM	Max Torque @ 90 psi	Weight	Length
UT8892HD-5*	500	200 in-lbs. **	1.05 lbs.	6.1"
UT8892HD-2.5*	250	250 in-lbs. **	1.05 lbs.	6.1"

### 9300 Series Selection Charts on the Following Pages

- \*\* Tool will accept Jiffy® modular Hi-Lok/Hi-Lite® installation attachments
- \* Installation attachment is rated at lower torque value than motor

® Hi-Lok and Hi-Lite are registered trademarks of the Hi-Shear Corporation.  
® Jiffy is a registered trademark of United Air Tool

# HI-LOK® MODULAR INSTALLATION TOOLS

## 9300 Series Selection Chart



HD5-9300-3125-785



HD5-9301-3125-785

Complete Tool Number	RPM	Modular Attachment Only	Socket Hex	Socket Length	Hex Tip Size	OAL	Socket Assembly Part Number
HD5-9300-2505-625	500	9300-2505-625	1/4"	1/2"	1/16"	8.250"	2505-625
HD5-9301-2505-625	500	9301-2505-625	1/4"	1/2"	1/16"	12.250"	2505-625
HD5-9300-2501-621	500	9300-2501-621	1/4"	1"	1/16"	8.750"	2501-621
HD5-9301-2501-621	500	9301-2501-621	1/4"	1"	1/16"	12.750"	2501-621
HD5-9300-2505-785	500	9300-2505-785	1/4"	1/2"	5/64"	8.250"	2505-785
HD5-9301-2505-785	500	9301-2505-785	1/4"	1/2"	5/64"	12.250"	2505-785
HD5-9300-2501-781	500	9300-2501-781	1/4"	1"	5/64"	8.750"	2501-781
HD5-9301-2501-781	500	9301-2501-781	1/4"	1"	5/64"	12.750"	2501-781
HD5-9300-3125-625	500	9300-3125-625	5/16"	1/2"	1/16"	8.250"	3125-625
HD5-9301-3125-625	500	9301-3125-625	5/16"	1/2"	1/16"	12.250"	3125-625
HD5-9300-3121-621	500	9300-3121-621	5/16"	1"	1/16"	8.750"	3121-621
HD5-9301-3121-621	500	9301-3121-621	5/16"	1"	1/16"	12.750"	3121-621
HD5-9300-3125-785	500	9300-3125-785	5/16"	1/2"	5/64"	8.250"	3125-785
HD5-9301-3125-785	500	9301-3125-785	5/16"	1/2"	5/64"	12.250"	3125-785
HD5-9300-3121-781	500	9300-3121-781	5/16"	1"	5/64"	8.750"	3121-781
HD5-9301-3121-781	500	9301-3121-781	5/16"	1"	5/64"	12.750"	3121-781
HD5-9300-3125-945	500	9300-3125-945	5/16"	1/2"	3/32"	8.250"	3125-945
HD5-9301-3125-945	500	9301-3125-945	5/16"	1/2"	3/32"	12.250"	3125-945
HD5-9300-3121-941	500	9300-3121-941	5/16"	1"	3/32"	8.750"	3121-941
HD5-9301-3121-941	500	9301-3121-941	5/16"	1"	3/32"	12.750"	3121-941

To order complete tool with 250 RPM use HD2.5 in the prefix. Tool Selection Chart Continues on Next Page.

### 9300 Series Tool Selection Chart

Complete Tool Number	RPM	Modular Attachment Only	Socket Hex	Socket Length	Hex Tip Size	OAL	Socket Assemb Part Number
HD5-9300-3435-625	500	9300-3435-625	11/32"	1/2"	1/16"	8.250"	3435-625
HD5-9301-3435-625	500	9301-3435-625	11/32"	1/2"	1/16"	12.250"	3435-625
HD5-9300-3431-621	500	9300-3431-621	11/32"	1"	1/16"	8.750"	3431-621
HD5-9301-3431-621	500	9301-3431-621	11/32"	1"	1/16"	12.750"	3431-621
HD5-9300-3435-785	500	9300-3435-785	11/32"	1/2"	5/64"	8.250"	3435-785
HD5-9301-3435-785	500	9301-3435-785	11/32"	1/2"	5/64"	12.250"	3435-785
HD5-9300-3431-781	500	9300-3431-781	11/32"	1"	5/64"	8.750"	3431-781
HD5-9301-3431-781	500	9301-3431-781	11/32"	1"	5/64"	12.750"	3431-781
HD5-9300-3435-945	500	9300-3435-945	11/32"	1/2"	3/32"	8.250"	3435-945
HD5-9301-3435-945	500	9301-3435-945	11/32"	1/2"	3/32"	12.250"	3435-945
HD5-9300-3431-941	500	9300-3431-941	11/32"	1"	3/32"	8.750"	3431-941
HD5-9301-3431-941	500	9301-3431-941	11/32"	1"	3/32"	12.750"	3431-941
HD5-9300-3755-785	500	9300-3755-785	3/8"	1/2"	5/64"	8.250"	3755-785
HD5-9301-3755-785	500	9301-3755-785	3/8"	1/2"	5/64"	12.250"	3755-785
HD5-9300-3751-781	500	9300-3751-781	3/8"	1"	5/64"	8.750"	3751-781
HD5-9301-3751-781	500	9301-3751-781	3/8"	1"	5/64"	12.750"	3751-781
HD5-9300-3755-945	500	9300-3755-945	3/8"	1/2"	3/32"	8.250"	3755-945
HD5-9301-3755-945	500	9301-3755-945	3/8"	1/2"	3/32"	12.250"	3755-945
HD5-9300-3751-941	500	9300-3751-941	3/8"	1"	3/32"	8.750"	3751-941
HD5-9301-3751-941	500	9301-3751-941	3/8"	1"	3/32"	12.750"	3751-941
HD5-9300-4385-785	500	9300-4385-785	7/16"	1/2"	5/64"	8.250"	4385-785
HD5-9301-4385-785	500	9301-4385-785	7/16"	1/2"	5/64"	12.250"	4385-785
HD5-9300-4381-781	500	9300-4381-781	7/16"	1"	5/64"	8.750"	4381-781
HD5-9301-4381-781	500	9301-4381-781	7/16"	1"	5/64"	12.750"	4381-781
HD5-9300-4385-945	500	9300-4385-945	7/16"	1/2"	3/32"	8.250"	4385-945
HD5-9301-4385-945	500	9301-4385-945	7/16"	1/2"	3/32"	12.250"	4385-945
HD5-9300-4381-941	500	9300-4381-941	7/16"	1"	3/32"	8.750"	4381-941
HD5-9301-4381-941	500	9301-4381-941	7/16"	1"	3/32"	12.750"	4381-941

Assemblies and Components Tool Selection Chart Continues on Next Page

## 9300 Socket Assembly, Socket & Hex Tip Selection Chart

Socket Assembly	Socket Hex	Socket Length	Hex Tip Size	Spring	Replacement Socket	Replacement Hex Tip
2505-625	1/4"	1/2"	1/16"	SC-100	S-2505	HT-625
2501-621	1/4"	1"	1/16"	SC-100	S-2501	HT-621
2505-785	1/4"	1/2"	5/64"	SC-100	S-2505	HT-785
2501-781	1/4"	1"	5/64"	SC-100	S-2501	HT-781
3125-625	5/16"	1/2"	1/16"	SC-100	S-3125	HT-625
3121-621	5/16"	1"	1/16"	SC-100	S-3121	HT-621
3125-785	5/16"	1/2"	5/64"	SC-100	S-3125	HT-785
3121-781	5/16"	1"	5/64"	SC-100	S-3121	HT-781
3125-945	5/16"	1/2"	3/32"	SC-100	S-3125	HT-945
3121-941	5/16"	1"	3/32"	SC-100	S-3121	HT-941
3435-625	11/32"	1/2"	1/16"	SC-100	S-3435	HT-625
3431-621	11/32"	1"	1/16"	SC-100	S-3431	HT-621
3435-785	11/32"	1/2"	5/64"	SC-100	S-3435	HT-785
3431-781	11/32"	1"	5/64"	SC-100	S-3431	HT-781
3435-945	11/32"	1/2"	3/32"	SC-100	S-3435	HT-945
3431-941	11/32"	1"	3/32"	SC-100	S-3431	HT-941
3755-785	3/8"	1/2"	5/64"	SC-100	S-3755	HT-785
3751-781	3/8"	1"	5/64"	SC-100	S-3751	HT-781
3755-945	3/8"	1/2"	3/32"	SC-100	S-3755	HT-945
3751-941	3/8"	1"	3/32"	SC-100	S-3751	HT-941
4385-785	7/16"	1/2"	5/64"	SC-100	S-4385	HT-785
4381-781	7/16"	1"	5/64"	SC-100	S-4381	HT-781
4385-945	7/16"	1/2"	3/32"	SC-100	S-4385	HT-945
4381-941	7/16"	1"	3/32"	SC-100	S-4381	HT-941

## Mission Statement

To lead our industry in quality and depth of products offered; while developing long term mutually beneficial business partnerships with valued customers and distributors alike.

To maintain and develop our established position as a US based manufacturer, and balance this with global manufacturing at carefully selected strategic partner factories, where our concepts of quality and dependability are shared.

851 Jupiter Park Lane  
Jupiter, FL 33458  
Toll-Free 800-327-9403  
Fax: (561) 575-9134  
Customer Service 800-356-3392  
[www.florida-pneumatic.com](http://www.florida-pneumatic.com)  
[www.universaltoolusa.com](http://www.universaltoolusa.com)

Distributed by:

UT Aircraft Catalog  
Part No. 000U12  
REV2017